

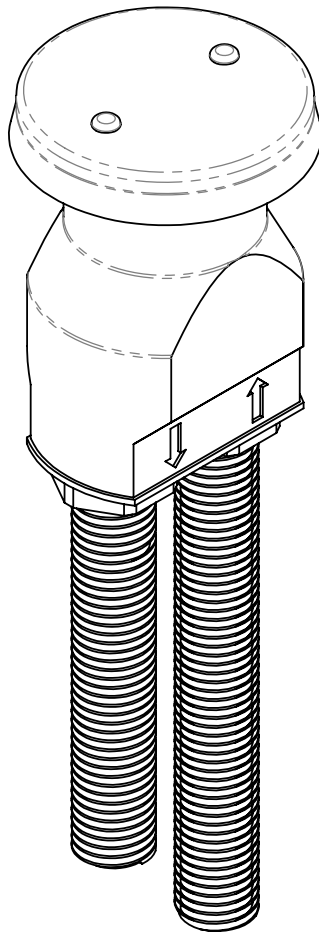

LANVAIN



Brise-vide / Vacuum breaker

UGS : B802A

Dimensions (pouces / inches)

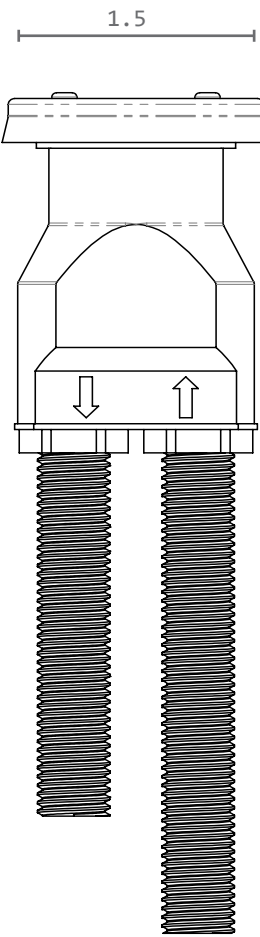
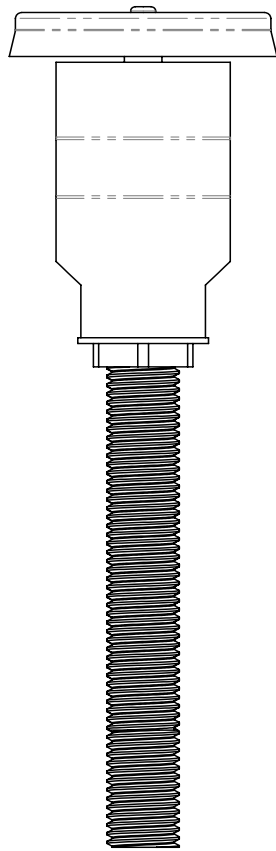
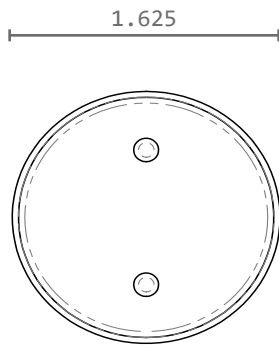

802A assemblage / assembly

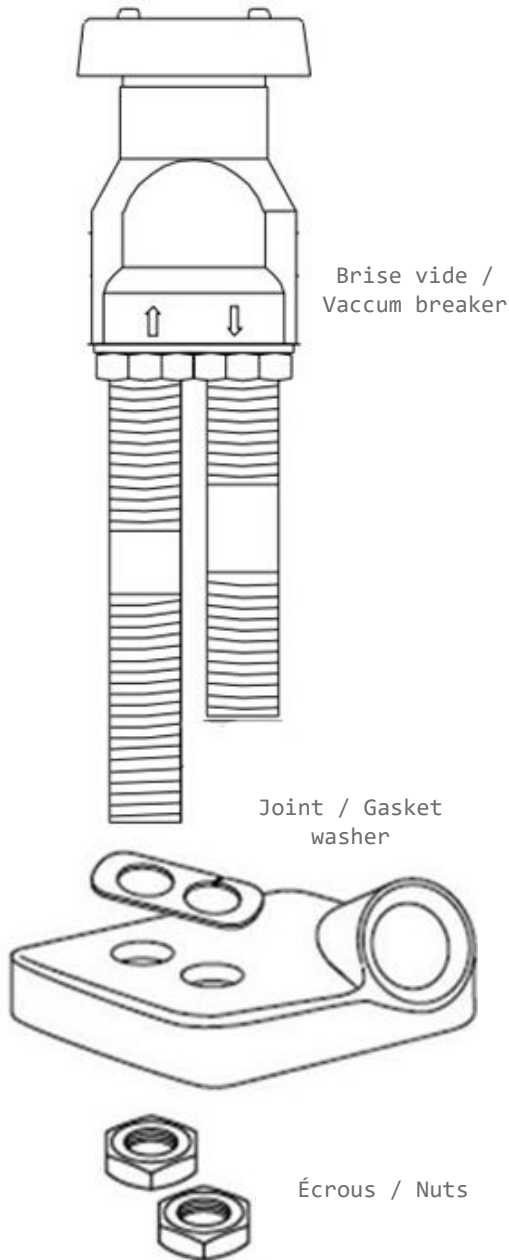

1. Insérer les tuyaux de laiton du brise vide au travers du joint et du support à douche. / Insert the vacuum breaker tailpieces through the gasket washer and the receiver cap.

2. Sécourir le brise vide au travers du support à douche à l'aide des 2 écrous. *Ne pas trop serrer* / Secure the vacuum breaker to the shower receiver with the 2 nuts. *Do not overtighten*

L'installation doit être fait par un plombier certifié, tel que démontré ci-haut. Si installé à l'envers, la douche risque de ne pas fonctionner. / *The installation must be done by a certified plumber, as shown above. If the vacuum breaker is installed backwards, the shower may be out of work.*





IAPMO R&T Product Listing



This IAPMO R&T Listing is current as of August 27, 2022

File Number:

7930

Issued To:

KAIPING XITE HARDWARE FACTORY

E3-3, DAJINGHENG ROAD, NO.3 INDUSTRIAL ZONE, SHUIKOU TOWN, KAIPING CITY KAIPING, GUANGDONG, CHINA

Product:

Plumbing Fixture Fittings

Products are in compliance with the following code(s):

Uniform Plumbing Code (UPC®)

National Plumbing Code of Canada

Products are certified to the following standard(s):

ASME A112.18.1-2018/CSA B125.1-18

